

To All Participants

AESJ Annual Conference 2021 (Ibaraki University, Online Conference)

Please read the followings before you join the conference.

-In general

- 1) Participants must have completed the registration and payment of the participation fee.
- 2) The link to access Zoom meeting room of each venue will be posted on the "Conference Program" page on the "special website for the annual conference" the day before the conference (scheduled). To know how to enter each venue, see page 2 and subsequent pages of this document. It is strictly forbidden to leak the zoom link information to unregistered people. Please recall that if paid registrants cannot enter the room due to the participation of unregistered people, it will infringe the rights of paid registrants.
- 3) When you enter the venue, mute the microphone and turn off the video.
- 4) Change your name on the screen to "Name (Affiliation)" [e.g. Taro Nokei (Tozai Univ.)]. (How to change your name: Click on "Participants." Find your name in the list of participants on the right side of the screen. Click on "Details" of your name. Select "Change Name", and write "Name (Affiliation)").

-Mini Symposium and Main Symposium

- 1) Mute the microphone and turn off the video unless instructed by the chair.
- 2) Questions to the chair / reporter will be accepted via the Google form. The URL for that will be displayed in the chat during the symposium.

-Oral presentations

- 1) Mute the microphone and turn off the video unless instructed by the chair.
- 2) If the chairman gives an instruction such as "If you have any questions, please unmute the microphone and speak. Please tell us your affiliation and name first.", You can unmute the microphone, turn on the video and ask a question. When your talk with the presenter ends, mute the microphone and turn off the video.

-Inquiry

- 1) Zoom meeting room as an information desk:
<https://zoom.us/j/97782697680?pwd=MnNuNG90UVpMUlpBeUs5eEVqNi9YQT09>
meeting ID : 97782697680 , passcode : 900552
- 2) E-mail, phone:
Narufumi Fukuyo : narufumi.fukuyo.agr@vc.ibaraki.ac.jp, 029-888-8616
Norikazu Kanada : kanada@nodai.ac.jp, 080-6778-0053

<How to participate in the conference>

(Note: The following explanation assumes that you have already created a "personal account" on the "Special Website for the Conference" and registered for participation. (for details, refer to the "Manual for the Special Website for the Annual Conference").

It is also assumed that the Zoom application is installed on your computer in advance.)

- (1) First, log in to the special site with the email address and password of your "personal account".

Enter your email address and password to log in.

- (2) When you log in, the My Page will appear. If you place the cursor on "Conference Program" from the menu bar at the top, a pull-down menu will appear. From the menu, you can select "Conference Program", "Search", or "Schedule".

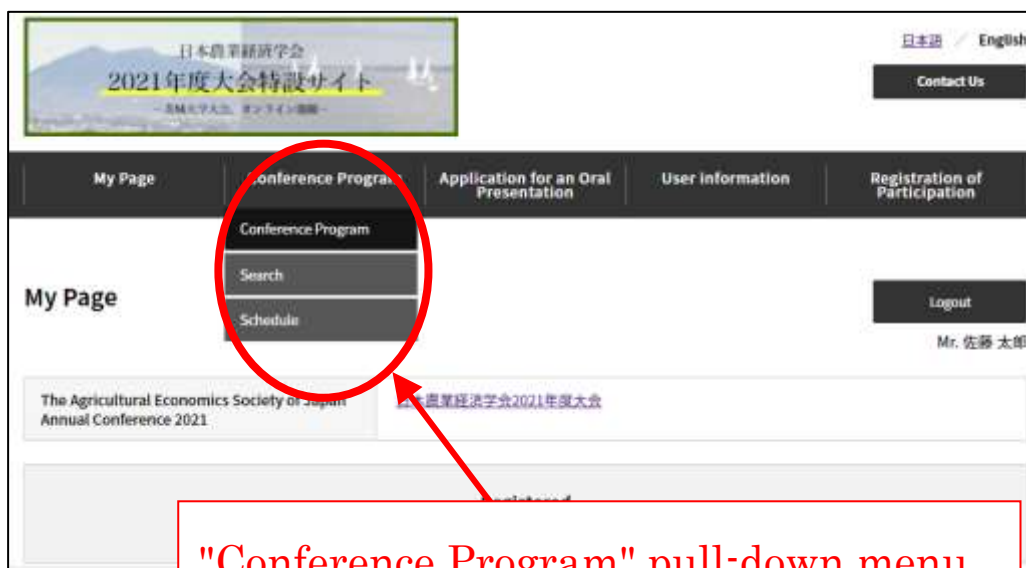

"Conference Program" pull-down menu

- (3) If you select "Search" from the pull-down menu on the previous page, you can search for presentations by keyword. Also, if you select "Schedule" from the pull-down menu, a calendar for each date will appear.

The following describes the case where you select "Conference Program" from the pull-down menu.

If you select "Conference Program" from the pull-down menu, the screen below will appear. From here, select 1) "Venue" and 2) "Date" to display the corresponding program. A box with the ZOOM link to the venue will pop up at the bottom. You can click the "ZOOM logo" in the box to jump to the venue.

The abstract of each presentation can be downloaded by clicking the "Abstract DL" button on the right.

1) Select "Venue".

Venue6 ="第 6 会場", Venue7 ="第 7 会場"

The screenshot shows the 'Conference Program' page. At the top right, there is a 'Logout' button and the user name 'Mr. 佐藤 太郎'. Below this is a grid of venue buttons: '第1会場', '第2会場', '第3会場', '第4会場', '第5会場', '第6会場', '第7会場', '予備会場1・インフォメーションデスク', and '予備会場2'. A red oval encircles this grid, with an arrow pointing to it from the instruction '1) Select "Venue".'. Below the venue grid, the '第1会場' section is expanded, showing '第1会場 Real-time Presentation'. Under this, there are three date buttons: 'All dates', '2021/3/27', and '2021/3/28'. A red oval encircles these date buttons, with an arrow pointing to it from the instruction '2) Select "Date".'. Below the date buttons, the date '2021/3/27' is highlighted in a blue bar. Underneath, there is a section for '開会・開催校挨拶'. At the bottom, a box contains a Zoom announcement: 'Please join us at Zoom when the announcement time comes.', a URL 'URL: https://zoom.us/j/93846362922?', and a 'zoom' logo. This box is circled in red, with an arrow pointing to it from the instruction '3) A Box with ZOOM link to the venue will pop up at the bottom. Click the "ZOOM logo" to jump to the venue.'.

3) A Box with ZOOM link to the venue will pop up at the bottom. Click the "ZOOM logo" to jump to the venue.

- (4) If you click the ZOOM logo in the pop-up box, the screen below will be displayed.
Click "Open zoom.us."

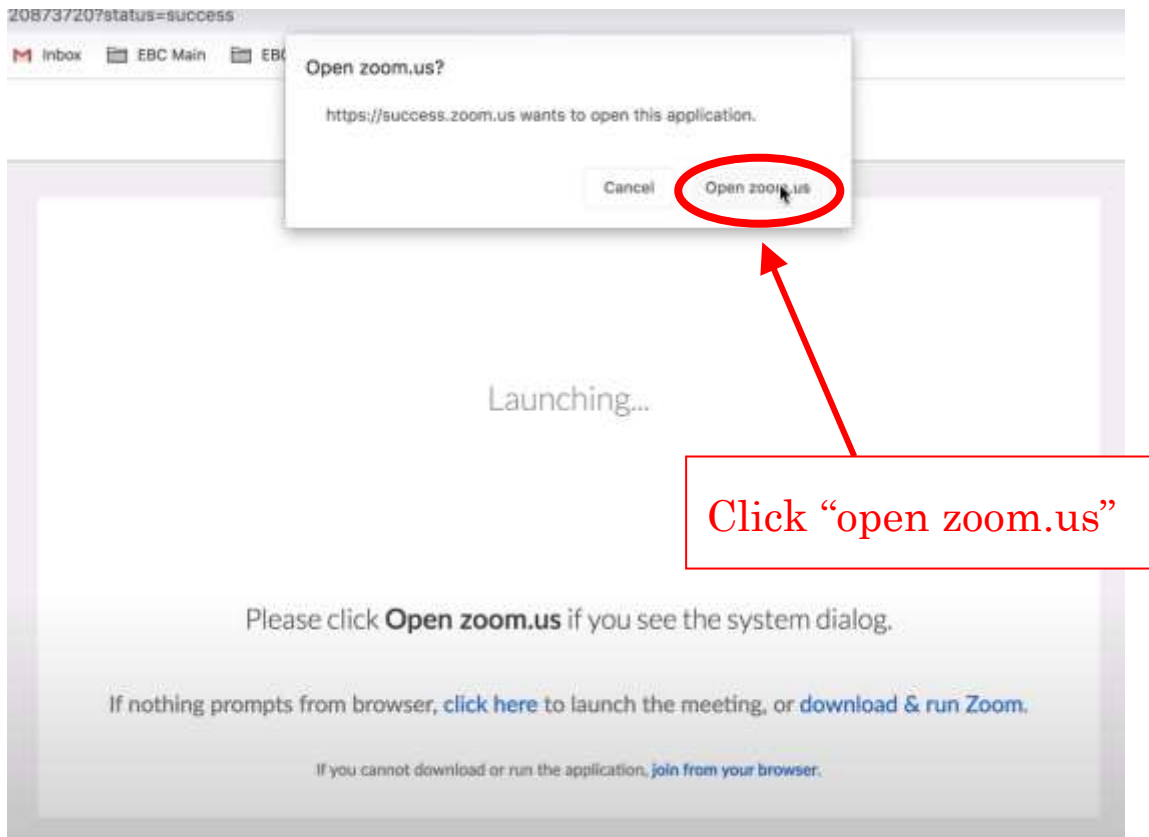

- (5) Click "Join With Computer Audio" to enter the venue.

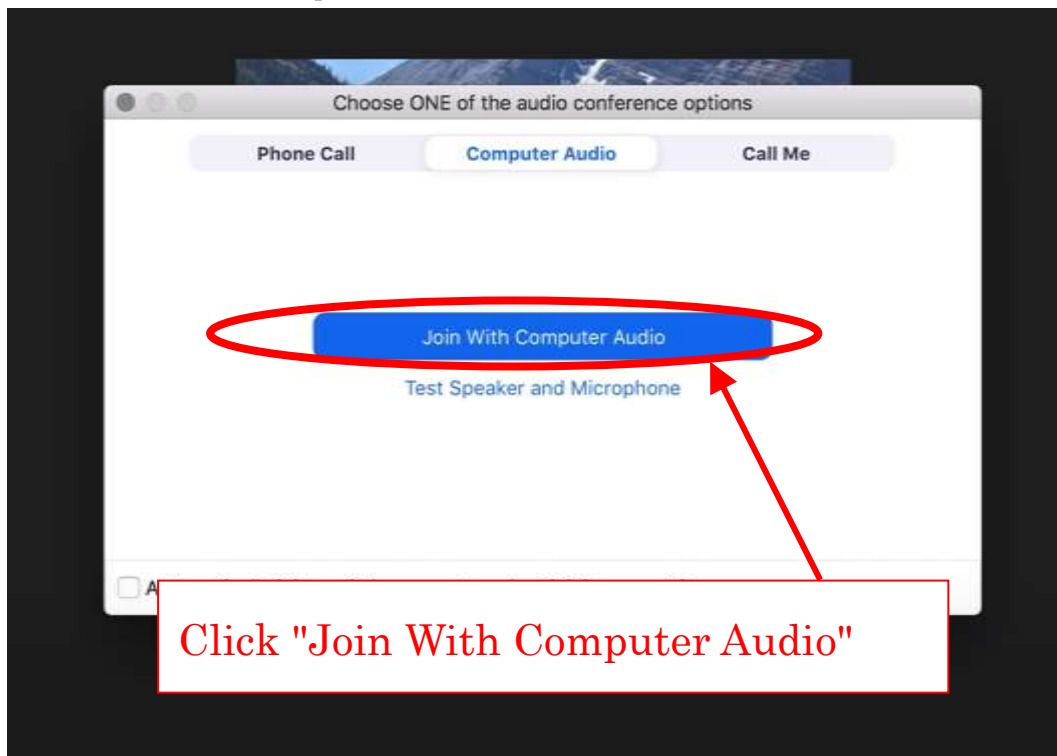

(6) The "Conference Program Page" explained on p.3 has the following several functions.

By clicking the "Add" button on the right of each presentation, you can list the presentation you want to hear on My Page.

The screenshot displays the conference program for 2021/3/28. The session is titled "6-1・2・3報告" with Session Chairman Satoru Shimokawa (Waseda University). Three presentations are listed:

- 09:00 - 09:25:** Measurement and Determinants of Exported Food Quality: Evidence from China's Firm-level Data. Presenters: Jie Mi (Kyushu University), Teruaki Nanseki*, Yosuke Chomei, Tinggui Chen. Buttons: Details (blue circle), Add (red circle).
- 09:25 - 09:50:** Computable General Equilibrium Analyses of Global Economic Impacts and Agriculture: the Case of COVID-19. Presenters: Koichi Yamaura* (Ritsumeikan Asia Pacific University), Shin Sakaue. Buttons: Details (blue circle), Add (red circle).
- 09:50 - 10:15:** How Agricultural Financialization Affects China's Sugar Market. Presenters: Peiran Su (Kyushu University), Teruaki Nanseki*, Yosuke Chomei. Buttons: Details (blue circle), Add (red circle).

At the bottom, there is a Zoom announcement: "Please join us at Zoom when the announcement time comes." with a Zoom logo and the URL: <https://zoom.us/j/...>. A blue arrow points from the "Details" button of the third presentation to the text box below.

Click the "Details" button to the right of each report to jump to the page where you can write a comment for the presenter.
However, the presenter will not be notified that the comment has been written, so it will only be communicated to the presenter when the presenter comes to see it later.

(7) The "Special Site for the Conference" can be logged in until April 26, 2021, but will be closed on April 27.